

ORDINANCE NO. 271

AN ORDINANCE ANNEXING TO THE CITY OF GREENLAND, ARKANSAS, A TRACT OF LAND IDENTIFIED IN "ORDER" ENTERED APRIL 22, 2008, BY HONORABLE JERRY HUNTON IN CASE NO. CC-2008-4 IN THE COUNTY COURT OF WASHINGTON COUNTY, ARKANSAS, AND FOR OTHER PURPOSES.

WHEREAS, over fifty percent (50%) of the owners of over fifty percent (50%) of the property described at Exhibit A hereto, which tract is adjacent to the City of Greenland, Arkansas, desire to be annexed into the City of Greenland, and is described as follows, to-wit:

Please See Exhibit "A" for Legal Description and Exhibit "B" for Map.

WHEREAS, the majority of the owners who own the majority of the land described at Exhibit A, have requested that the above described tract of real property be annexed to the City of Greenland, Arkansas.

WHEREAS, the majority of the owners of a majority of the land described at Exhibit A, prosecuted an action before the County Court of Washington County, Arkansas, securing an "Order" on April 22, 2008.

WHEREAS, said property meets at least two of the Vestal criteria in that it is being held for sale or use as municipal lots and/or suburban property and that it represents the actual growth of the City of Greenland beyond its legal boundary.

BE IT ORDAINED BY THE CITY COUNCIL OF THE CITY OF GREENLAND,
ARKANSAS,

SECTION 1: That the tract of land described at Exhibit A hereto and situate in Washington County, Arkansas is hereby accepted as an annexation to the City of Greenland, Arkansas.

SECTION 2: It is hereby determined that the tract of real property is contiguous and adjacent to other lands in Greenland, Arkansas, which are located in Ward 4, and therefore such tract of land described at Exhibit A is determined and declared to all be in Ward 4, of the City of Greenland.

SECTION 3: The official Zoning Districts map of the City of Greenland, Arkansas, is hereby amended to show the annexation to the City of the tract of real property described at Exhibit A and such tract is hereby zoned A-1.

PASSED AND APPROVED this 9th day of June, 2008.

JOHN GRAY, Mayor

ATTEST:



DONNA CHEEVERS, Recorder/Treasurer

EXHIBIT A

Land situate in Washington County, Arkansas, and contiguous to Greenland, to wit:

Starting at the NW corner of the SE1/4 NW1/4 of S8, T15N, R30W; thence S 02°12'00" W 67.7 feet; thence S 89°41'06" E 1 foot to the point of beginning on the Greenland city limit line; thence S 87°38'22" E 178.8 feet; thence N 05°10'27" W 36.5 feet to the city limit line; thence running along the city limit line S 75°27'35" E 3.9 feet; thence S 66°13'54" E 43.35 feet; thence S 00°16'12" E 19.55 feet; thence S 87°46'58" E 75.13 feet to the city limit line; thence along the city limit line S 80°04'29" E 25.62 feet; thence S 80°56'56" E 80.08 feet to the E line of the SE1/4 NW1/4 of S8, T15N, R30W; thence S 81°23'09" E 84.82 feet; thence S 87°38'50" E 17.89 feet; thence S 87°38'50" E 15.712 feet; thence N 89°37'46" E 131.04 feet; thence S 02°15'38" W 72.14 feet; thence S 87°32'45" E 141.83 feet; thence S 03°04'07" W 91.93 feet; thence N 88°17'00" E 10.95 feet to the E line of the SW1/4 NE1/4 of said S8; thence running southerly along said line S 02°06'35" W 145.09 feet; thence N 87°51'23" W 682.22 feet; thence S 00°57'29" W 133.62 feet; thence N 86°47'09" W 121.89 feet; thence S 02°16'49" W 281.79 feet to the city limit line; thence S 87°38'17" E 54.51 feet along said line; thence S 36°46'40" E 73.09 feet; thence S 31°29'18" E 20.34 feet; thence S 23°35'22" E 19.655 feet; thence S 14°16'44" B 27.468 feet; thence S 09°54'51" E. 159.37 feet; thence N 87°06'02" W 560.675 feet to the E line of S7, T15N, R30W; thence southerly along said line S 02°18'59" W 133.41 feet; thence N 86°49'12" W 187.31 feet; thence N 11°12'44" E 1217.759 feet to the NW corner of the SW1/4 NW1/4 of S8, T15N, R30W, same point being on the city limit line; thence southerly along said line S 02°24'52" W 403.026 feet; thence S 87°46'01" E 398.864 feet along said line; thence N 02°21'42" E 338.307 feet along said line to the P.O.B., less and except all Arkansas State Highway Commission right-of-way, and containing 159.78 acres more or less.

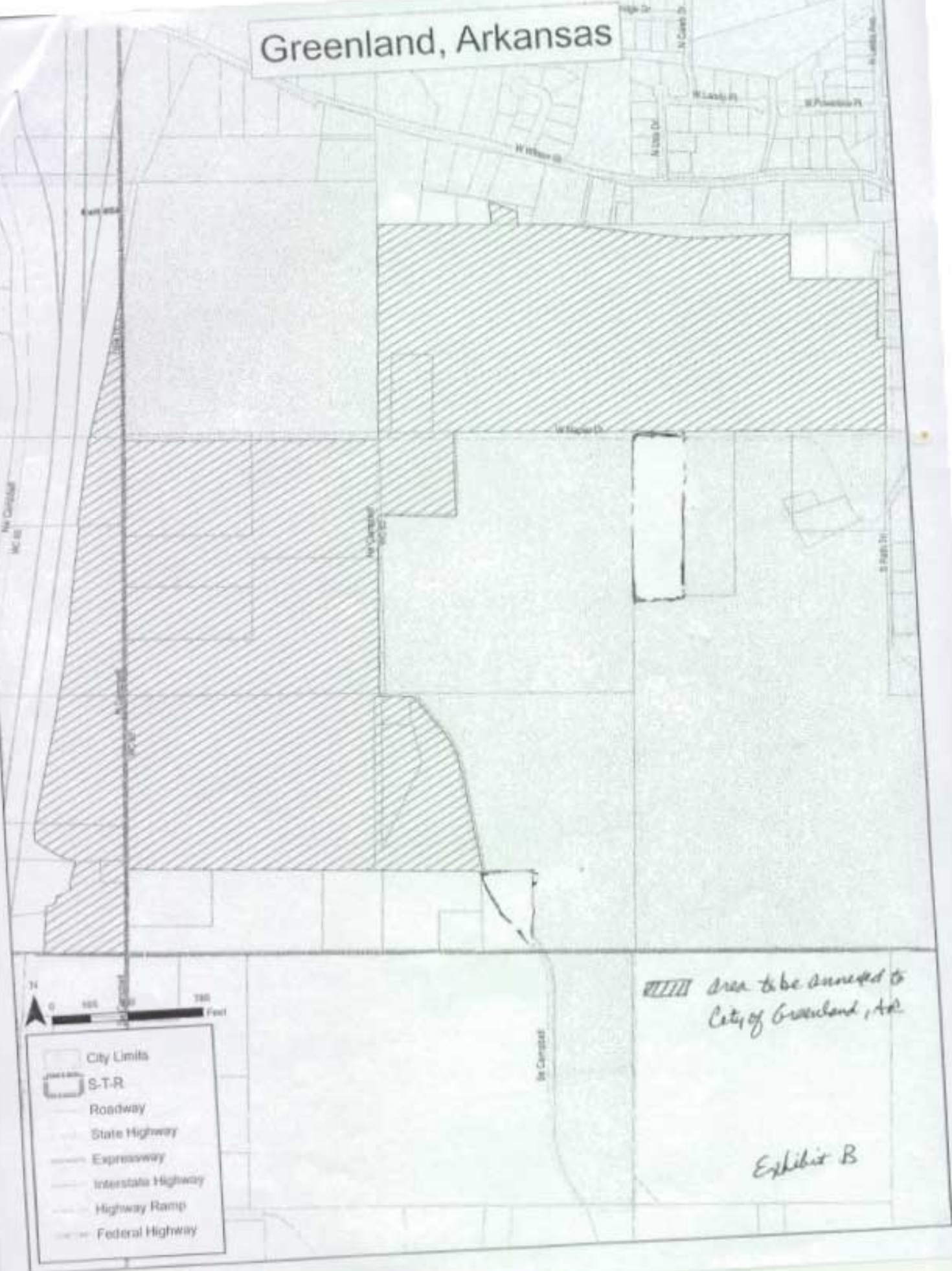
Greenland, Arkansas



[Hatched Box] Area to be annexed to
City of Greenland, Ark.

Exhibit B